

Straumann Screw-retained Prosthetics

Straumann® Screw-retained Abutments

Straumann Screw-retained abutments	Indication and product features
	<p data-bbox="943 523 1906 683">Abutments for fixed screw-retained restorations; for multi-unit and single-unit restorations</p> <ul data-bbox="943 775 2000 1377" style="list-style-type: none">▪ Available in different gingiva heights▪ Available with different angulations▪ Compatible with Straumann Bone Level Implants (for NC / RC)▪ Round-off edges and steep abutment connector angle of 22°▪ Same abutment connector geometry for all platforms to allow small component portfolio▪ Design allows abutment-level impression▪ Consistent Straumann colour coding

Abutment technical features

Requirements for tilted implant type restorations

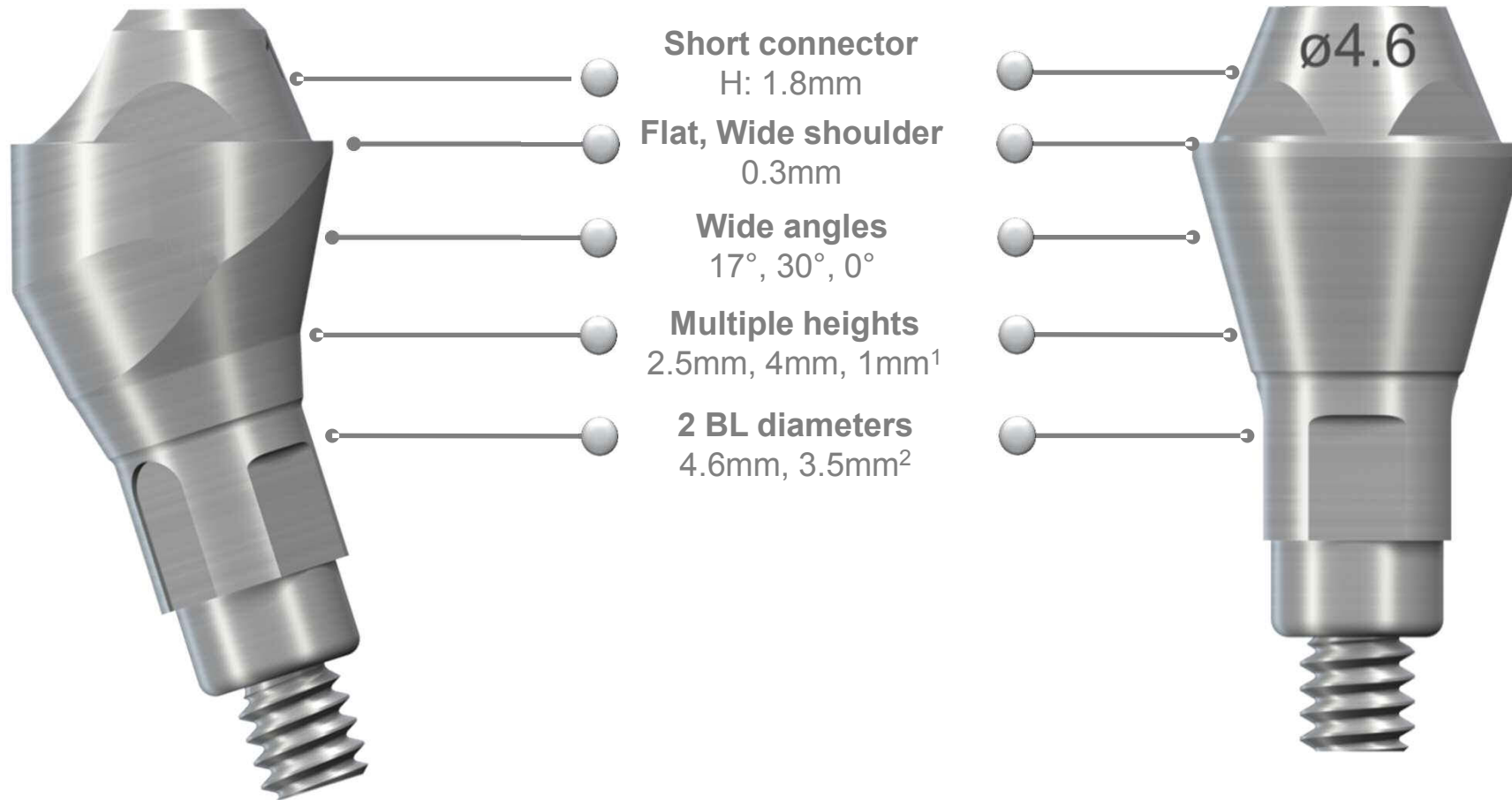

Abutment technical features

Requirements for tilted implant type restorations

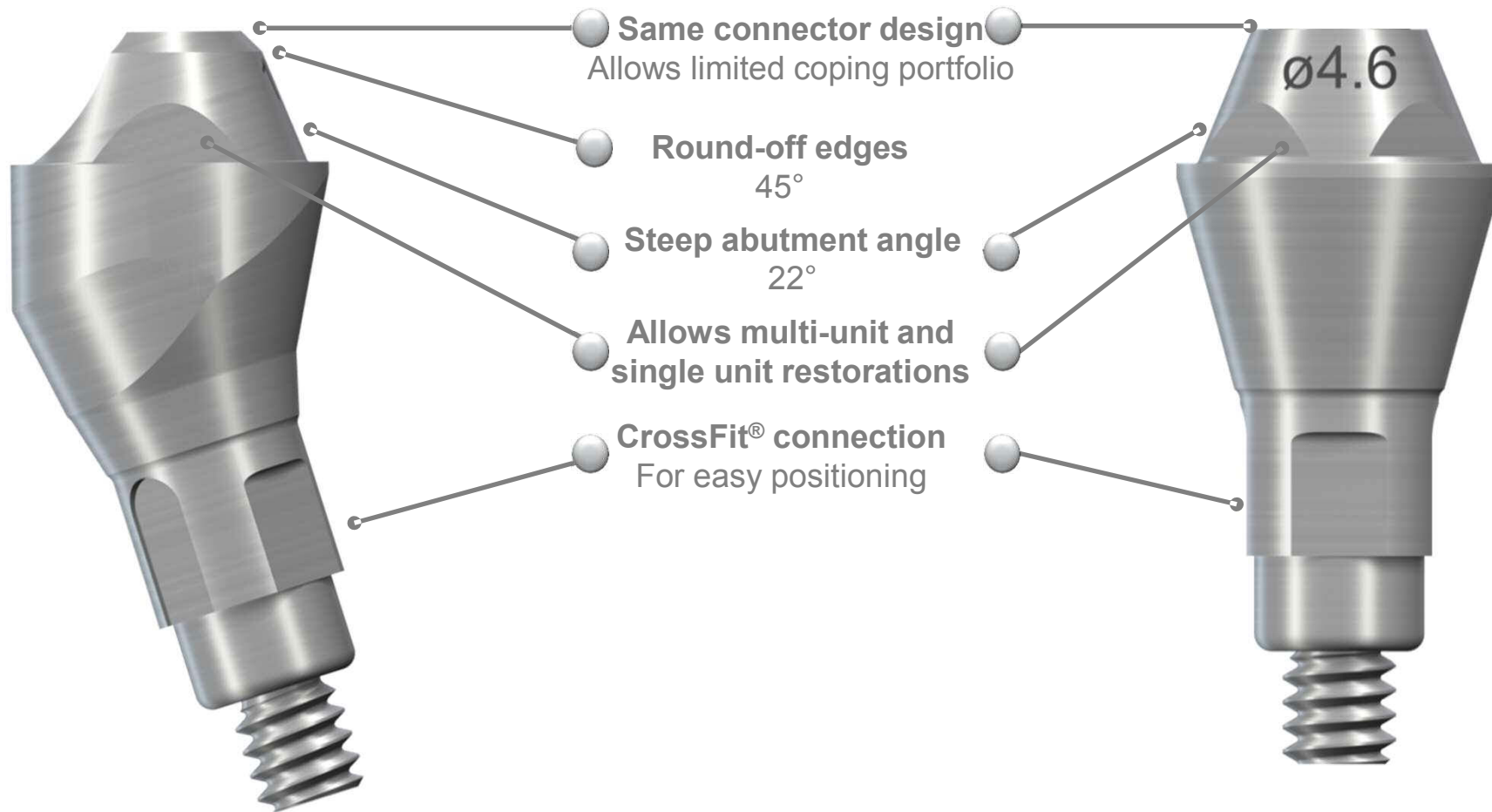

Abutment connector new features

(example RC abutment, straight & angled, GH 2.5mm)

- New angulations: 17° & 30°
- Reduced abutment dimension
- Same connector geometry → limited coping portfolio
- Connector allows multi-unit as well as single-unit restorations

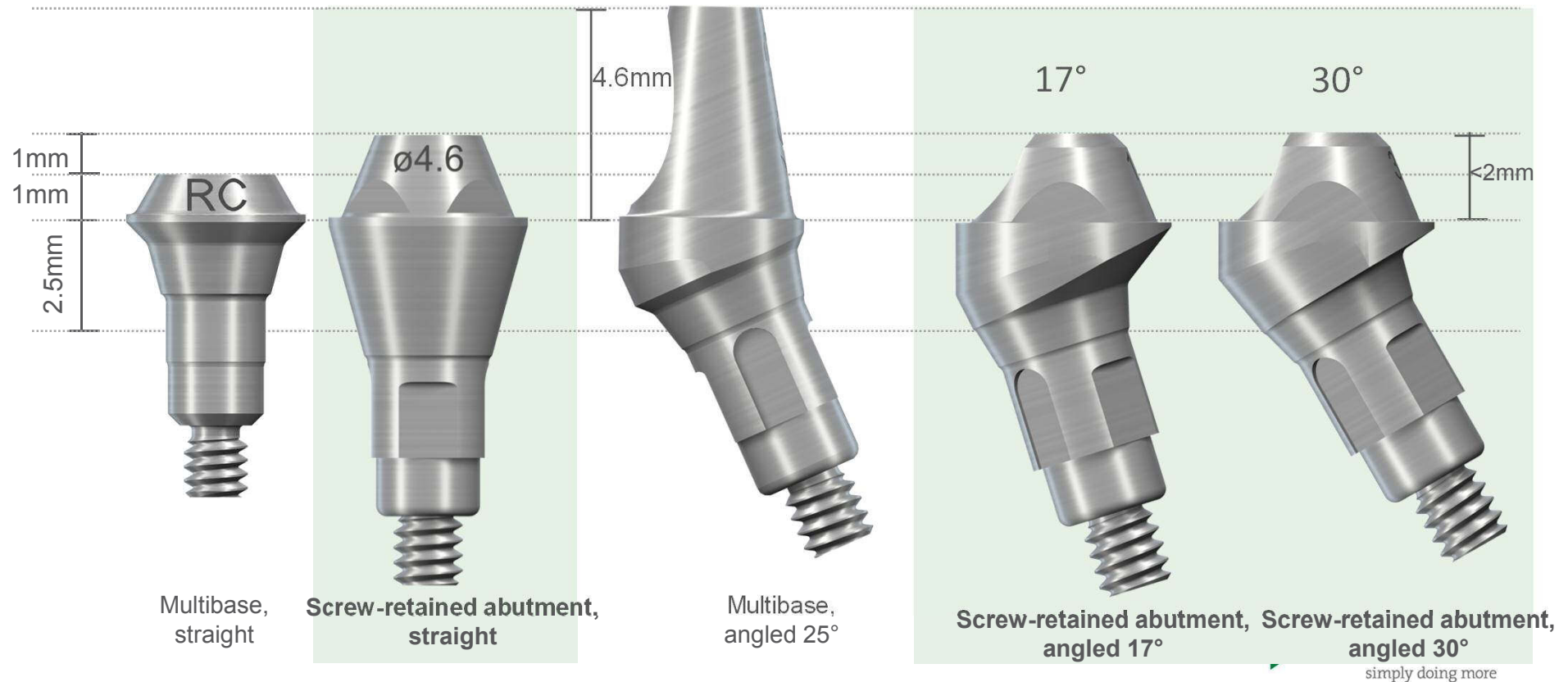

Gingiva heights (angled abutments)

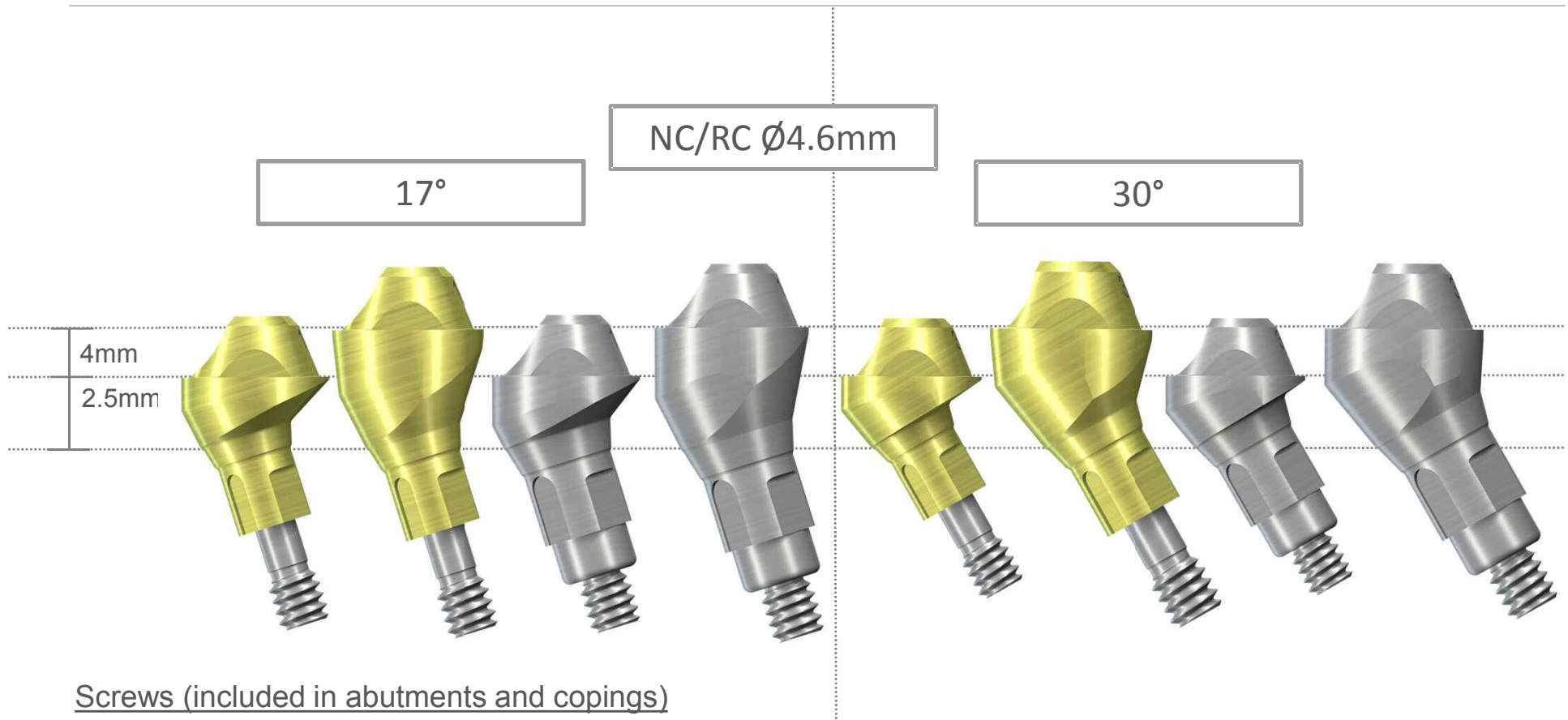

Screws (included in abutments and copings)

Basal screw

NC
#025.0002

RC
#025.0002

Occlusal screw

#023.4763

Gingiva heights (straight abutments)

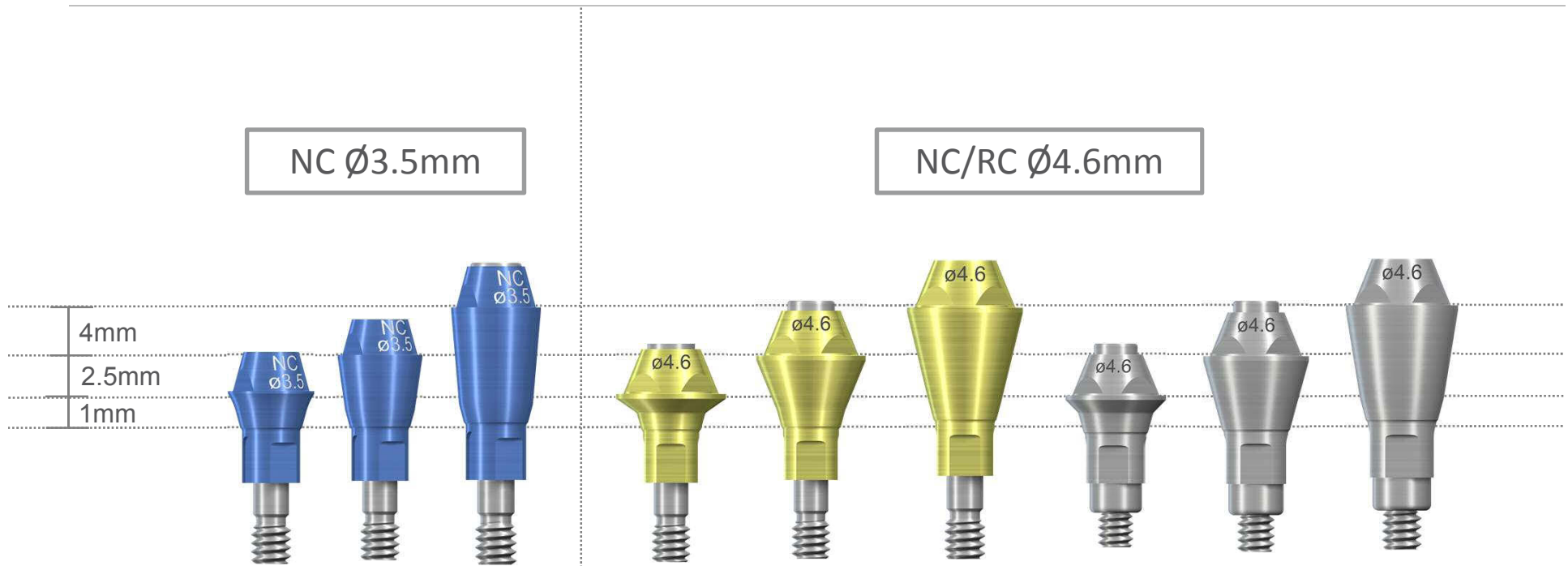

Screws (included in abutments and copings)

Basal screw	GH 1: #023.4749	GH 2: #023.4750	GH 3: #023.4760
Occlusal screw	#023.4763		

Limited Indications for NC 0° Ø3.5 & Ø4.6, GH 1.0mm Abutment



		0°		17°		30°		0°		17°		30°	
Connection		NC		NC						RC			
D		3.5		4.6						4.6			
Typ				A	B	A	B		A	B	A	B	
GH	1.0	●	●	--	--	--	--	●	--	--	--	--	
	2.5	●	●	●	●	●	●	●	●	●	●	●	
	4.0	●	●	●	●	●	●	●	●	●	●	●	

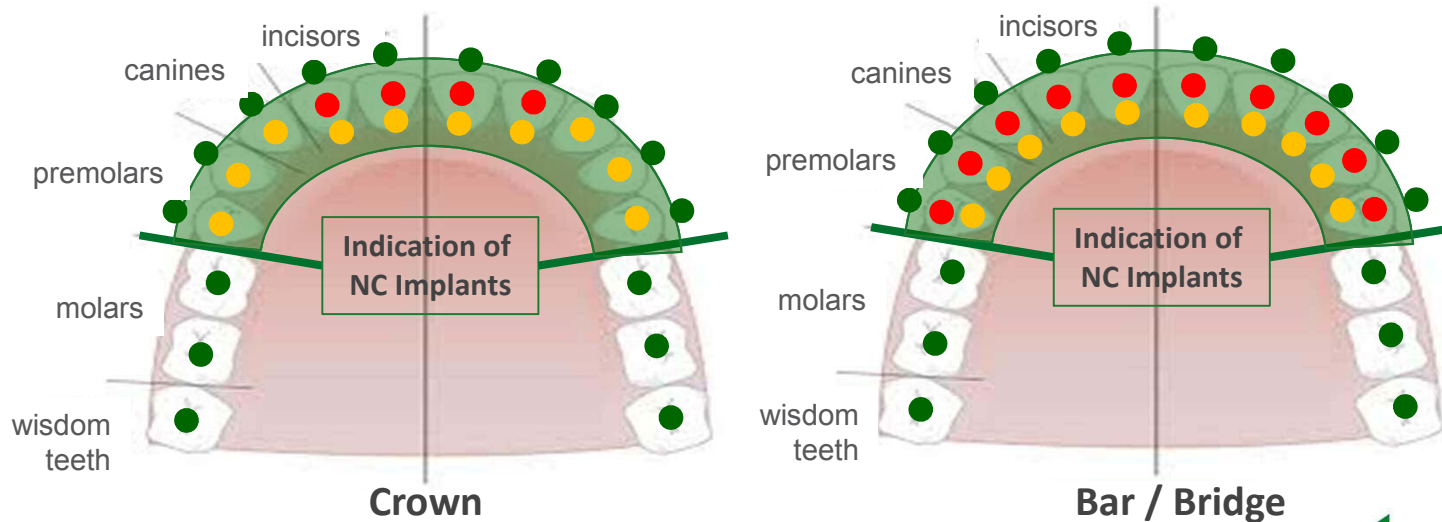

Copings

Components for Straumann Screw-retained abutments	Indication and product features
	<p data-bbox="936 523 1825 632">Immediate temporization possible with Titanium copings</p> <ul data-bbox="936 660 2007 1054" style="list-style-type: none"><li data-bbox="936 660 2007 823">■ Titanium copings allow production of temporary restoration to be placed in patient's mouth immediately<li data-bbox="936 836 2007 938">■ Convert existing patient's denture into temporary restoration<li data-bbox="936 951 2007 1002">■ Polymer copings for burn-out techniques<li data-bbox="936 1015 2007 1054">■ Bar copings for conventional final prosthesis

Technical features:

Abutment connector design and copings

Connector Geometry

- Straight and angled abutments with same abutment connector geometry → limited coping portfolio
 - Same copings for straight / angled abutments D 4.6mm
 - Same copings for straight abutments D 3.5mm

Multi-unit/single unit restoration

- Engaging/non-engaging feature integrated in copings

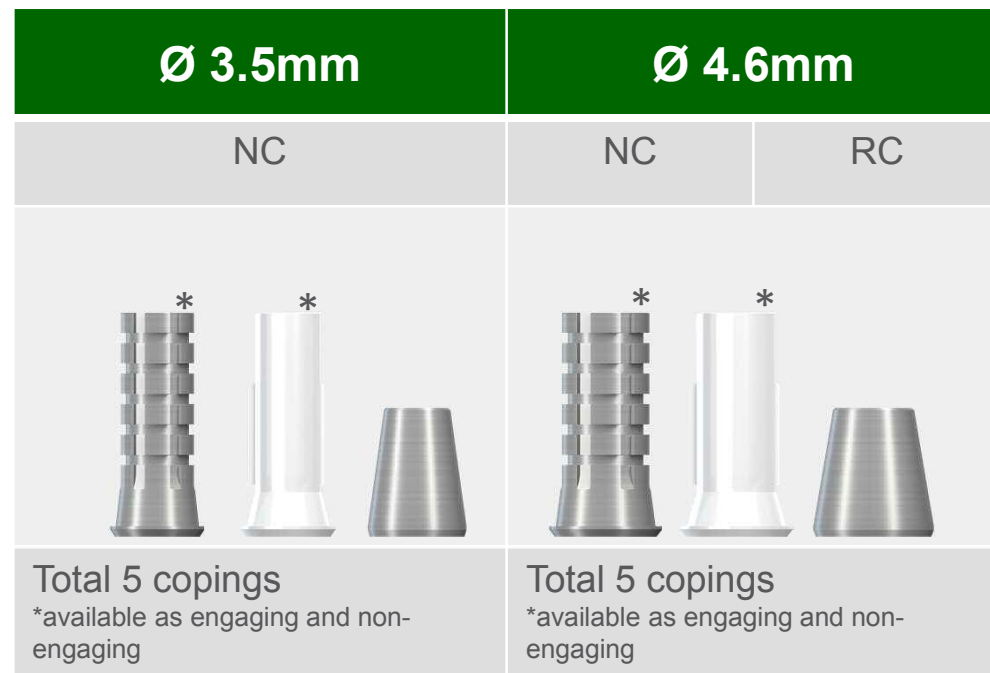

Engaging

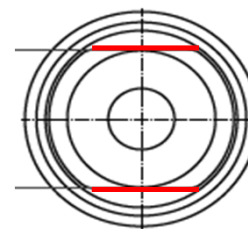



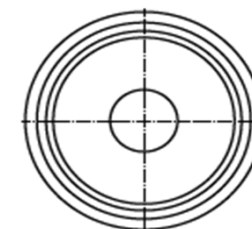



Non-Engaging



Technical features:

Abutment connector design and copings

- Compared to the current Multibase coping portfolio the new coping portfolio for Straumann® Screw-retained abutment is limited thanks to the new connector geometry

	RC Multibase		RC Screw-retained abutment	
	Straight, $\varnothing 4.5\text{mm}$	Angled, $\varnothing 4.0\text{mm}$	Straight, $\varnothing 4.6\text{mm}$	Angled, $\varnothing 4.6\text{mm}$
Non-engaging				
engaging				

Technical Feature:

Screw-in-screw concept

Straight abutments have a screw-in-screw-concept:

- The occlusal screw is screwed into the basal screw
- For reduced height of the restoration
- Both screws to be used with the SCS screwdriver

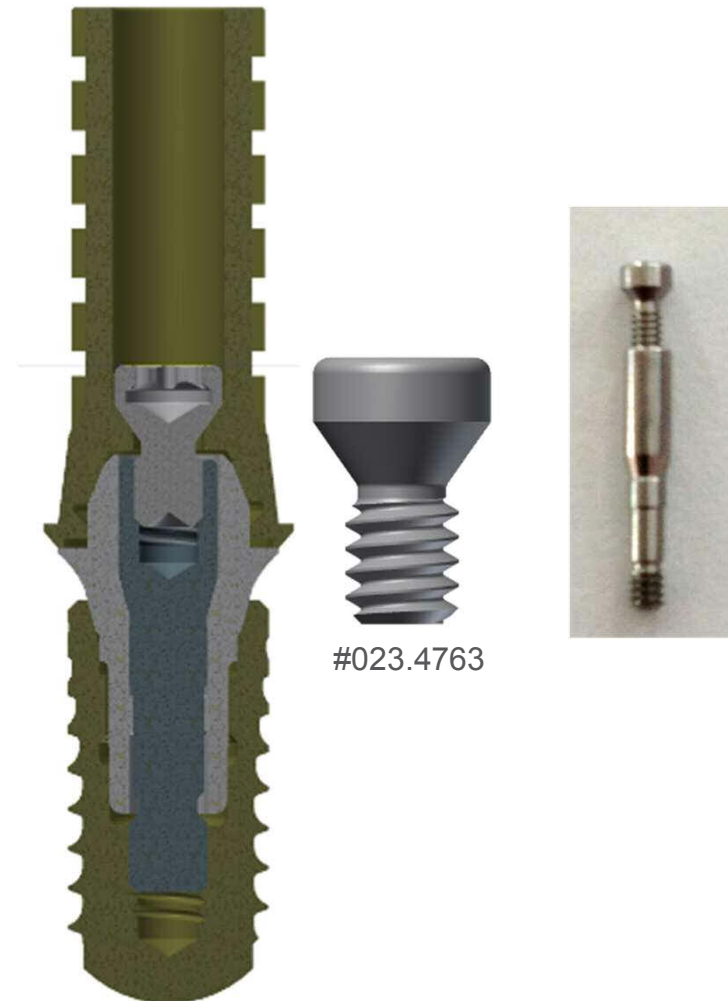

Impression Taking

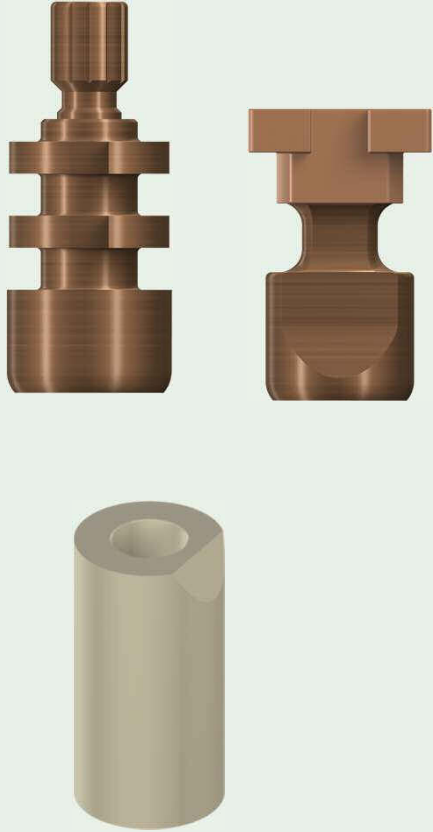
Components for Straumann Screw-retained abutments	Indication and product features
	<p data-bbox="936 523 1939 627">Impression taking on abutment-level: either traditional or via scanbodies</p> <p data-bbox="936 659 1552 707">Traditional impression-taking</p> <ul data-bbox="936 719 1798 914" style="list-style-type: none">▪ On abutment-level▪ Open tray or closed tray▪ For both diameters: Ø3.5 / Ø4.6mm▪ Reflects existing Straumann colour coding <p data-bbox="936 983 1193 1031">Scanbodies</p> <ul data-bbox="936 1043 1977 1385" style="list-style-type: none">▪ Base for digitally processing CARES® hybrid bars and wrap around bars (via dental models)▪ For scanning on abutment-level▪ Internal geometry reflects Screw-retained abutment design▪ For both diameters: Ø3.5 / Ø4.6mm▪ Material PEEK

New Impression components compared to Multibase



025.4242, open tray impression post

same design, same material
same procedure →



025.2244, open tray impression post



025.4241-04, closed tray impression post, plastic post to be snapped onto abutment



025.2246, closed tray impression post, **Metal post** screwed onto abutment, plastic positioning cap

Bar copings - dimensions

Ø 3.5mm		Ø 4.6mm	
NC		NC	RC
SKU: 023.2750		SKU: 023.4752 (same for NC and RC 4.6mm)	
			

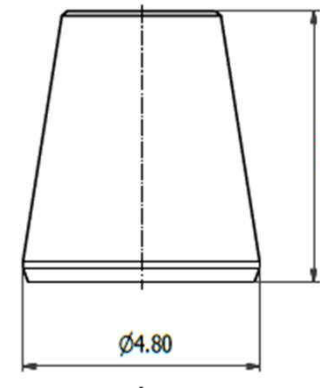
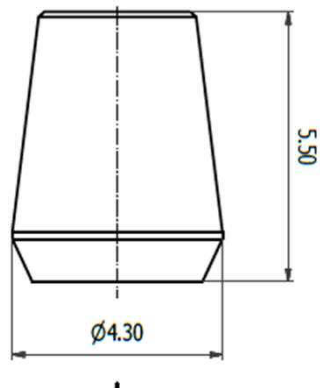

Protective caps - dimensions

Ø 3.5mm		Ø 4.6mm	
NC		NC	RC
SKU: 024.2323 / .2324 / .2325 (available in V4)		SKU: 024.4323 / .4324 / .4325 (same for NC and RC 4.6mm)	
			



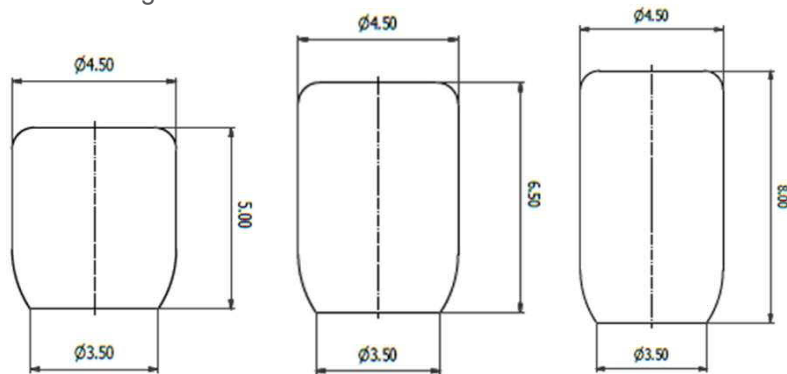

3 different heights: 5mm / 6.5mm / 8mm

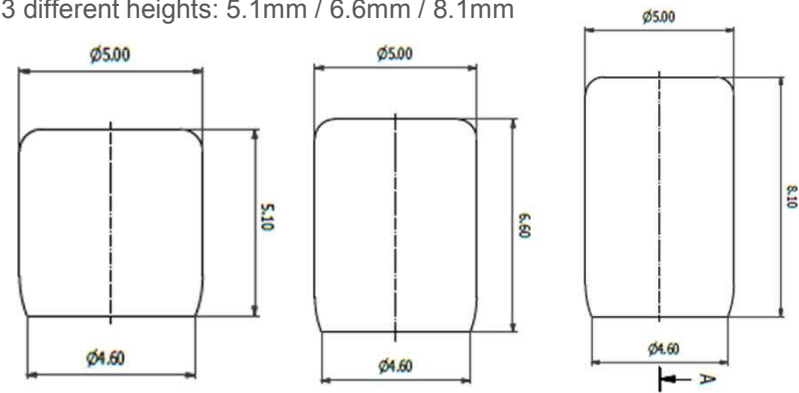









3 different heights: 5.1mm / 6.6mm / 8.1mm



Comparison Nobel Biocare Multi-unit Abutment and Straumann® Screw-retained Abutment

	Straumann		Nobel Biocare	
	Straight	Angled	Straight	Angled
				
Abutment Design				
Implant Diameters	BL: NC Ø 3.5mm NC Ø 4.6mm RC Ø 4.6mm	BL: NC Ø 3.5mm NC Ø 4.6mm RC Ø 4.6mm	Different abutments for: - external connection (Branemark / Nobel Speedy Groovy) - Internal conical connection (Nobel Active / Replace) - Internal Three-Part connection (Nobel Replace / Replace Select / Nobel Speedy Replace)	
Angulations	0°	17° / 30°	0°	17° / 30°
Gingiva Heights	1, 2.5, 4mm	2.5, 4mm	1-5mm depending on implant type	2-5mm depending on implant type
Auxiliary Portfolio	Due to abutment connector design, same copings for straight and angled abutments		Different copings for angled and straight abutments	
Abutment Connector Design				
Connector Height	1.8mm	1.8mm	<2mm	<2mm
Abutment Connector Angle	22°	22°, plus round off edges 45°		
Shoulder	Flat and 0.3mm wide	Flat and 0.3mm wide	flat	flat











Who is who in the new Straumann Screw-retained abutment portfolio

Multibase	NC Ø3.5	NC Ø4.0	RC Ø4.0	NC Ø4.5	RC Ø4.5	RC Ø6.5
						
	0°	25°, Type A/B	25°, Type A/B	0°	0°	0°
Gingiva Heights	1 2.5 4	-- 2.5 --	-- 2.5 --	1 2.5 4	1 2.5 4	1 2.5 4
Screw-retained Abutment	NC Ø3.5	NC Ø4.6	RC Ø4.6	NC Ø4.6	RC Ø4.6	
						
	0°	17°/ 30° A/B	17°/ 30° A/B	0°	0°	
	1 2.5 4	-- 2.5 4	-- 2.5 4	1 2.5 4	1 2.5 4	
Copings	NC Ø3.5	NC/RC Ø4.6,				
		<p>due to the new abutment connector geometry, the new copings are not compatible with Multibase abutments</p>				

Who is who in the new Straumann Screw-retained abutment portfolio - Copings

Multibase	NC Ø3.5	NC Ø4.0	RC Ø4.0	NC Ø4.5	RC Ø4.5	RC Ø6.5
						
	0°	25°, Type A/B	25°, Type A/B	0°	0°	0°
Copings						
Bridge – Gold	023.2731	023.2701	023.4701	023.2741	023.4741	023.4761
Bridge – Polymer	023.2734	023.2704	023.4704	023.2744	023.4744	023.4764
Bar – Gold	023.2732	023.2702	023.4702	023.2742	023.4742	023.4762
Bar - Polymer	023.2736	023.2706	023.4706	023.2746	023.4746	023.4766
Screw-retained Abutment	NC Ø3.5	NC Ø4.6	RC Ø4.6	NC Ø4.6	RC Ø4.6	
						
	0°	17°/ 30° A/B	17°/ 30° A/B	0°	0°	
Copings						
Titanium – engaging	023.2747		023.4747			
Titanium – non-eng.	023.2749		023.4751			
Titanium – Bar	023.2750		023.4752			
Polymer – engaging	023.2748		023.4748			
Polymer – non-eng.	023.2755		023.2755			

Product Portfolio for new Screw-retained Prosthetics

Portfolio Overview	NC Ø 3.5mm	NC/RC Ø 4.6mm
Copings¹ (engaging/non-engaging)		
Impression parts² Analogs Screws		
Abutments Straight	 GH 1, 2.5, 4mm	 GH 1, 2.5, 4mm
Abutments Angled		 17°/30° A/B GH 2.5, 4mm
Plan Abutments	 GH 2.5	 17°/30° A/B GH 2.5
Ac Planning Guide	 CAUTION wrap around bar	<p>¹Titanium coping / Burn-out coping / Bar coping Titanium / gold / Protective cap ²abutment-level impression closed/open tray / implant-level impression as existing ³available in Q3 2014</p>

www.straumann.com